

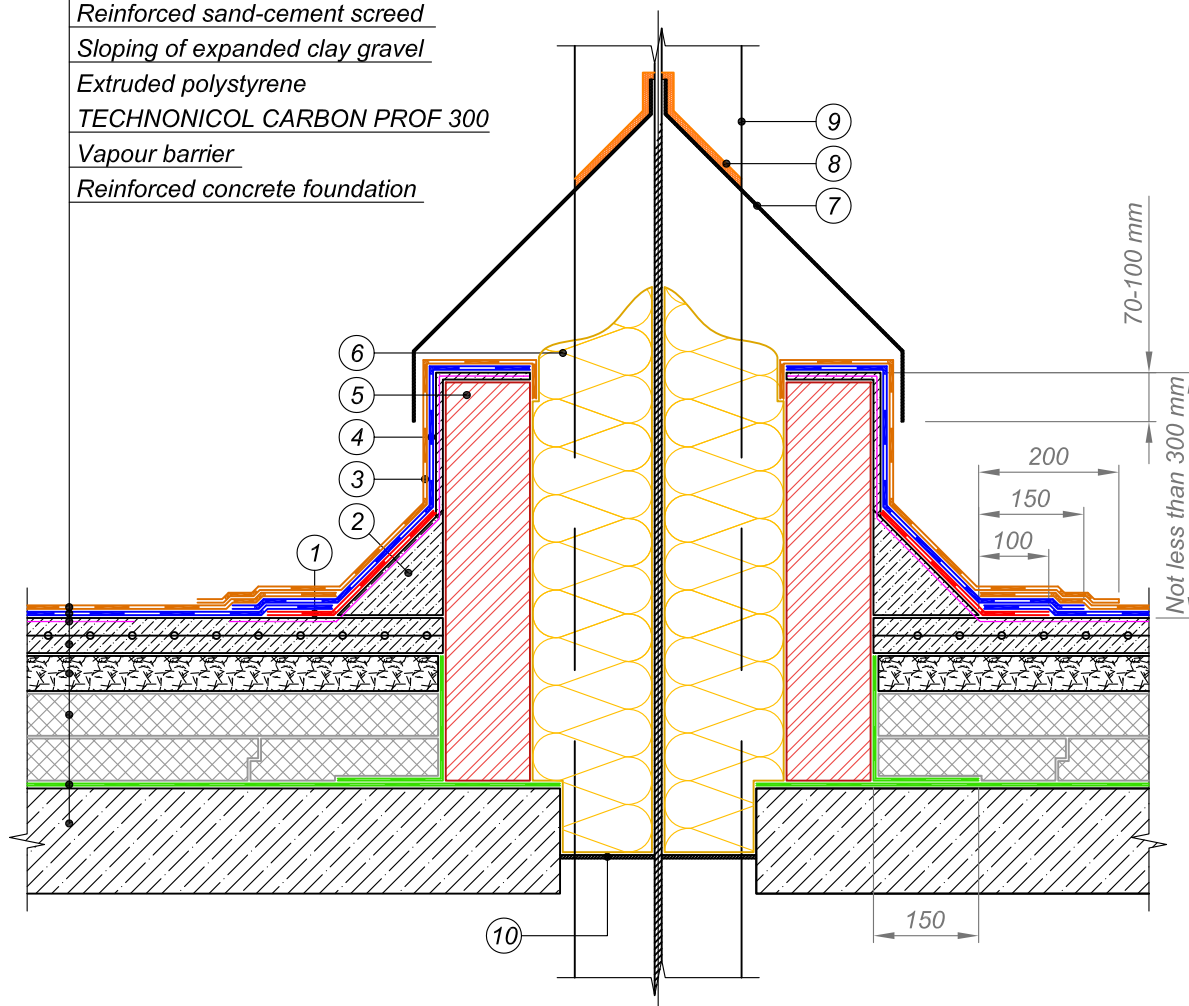

Cap sheet torch-on bitumen membrane  
Underlay torch-on bitumen membrane  
Bitumen primer TECHNICAL No. 01  
Reinforced sand-cement screed  
Sloping of expanded clay gravel  
Extruded polystyrene  
TECHNICAL CARBON PROF 300  
Vapour barrier  
Reinforced concrete foundation



- |   |  |
|---|--|
| <p>① Additional layer of waterproofing membrane - Underlay bitumen membrane</p> <p>② Transitional upstand of lightweight concrete</p> <p>③ Top layer of waterproofing system at junction - Cap sheet bitumen membrane</p> <p>④ Bottom layer of waterproofing system at junction - Underlay bitumen membrane</p> <p>⑤ Brickwork plastered with cement-sand grout</p> | <p>⑥ Stone wool thermal insulation not less than 120 mm in thickness</p> <p>⑦ Metal flashing not less than 3 mm in thickness should overlap the duct by 70-100 mm</p> <p>⑧ Weld flashing to the column and treat the joint with sealing mastic</p> <p>⑨ Rolled metal column</p> <p>⑩ Weld the metal plate and apply sealant around the perimeter</p> |
|---|--|

EXPOSED FLAT ROOF				DESIGN	APPROVED
ROLLED METAL COLUMN PASSING THROUGH THE ROOF. VARIANT 2				SCALE	DATE
REV.	DATE	DESCRIPTION	CHECKED	DWG No.	REV.