

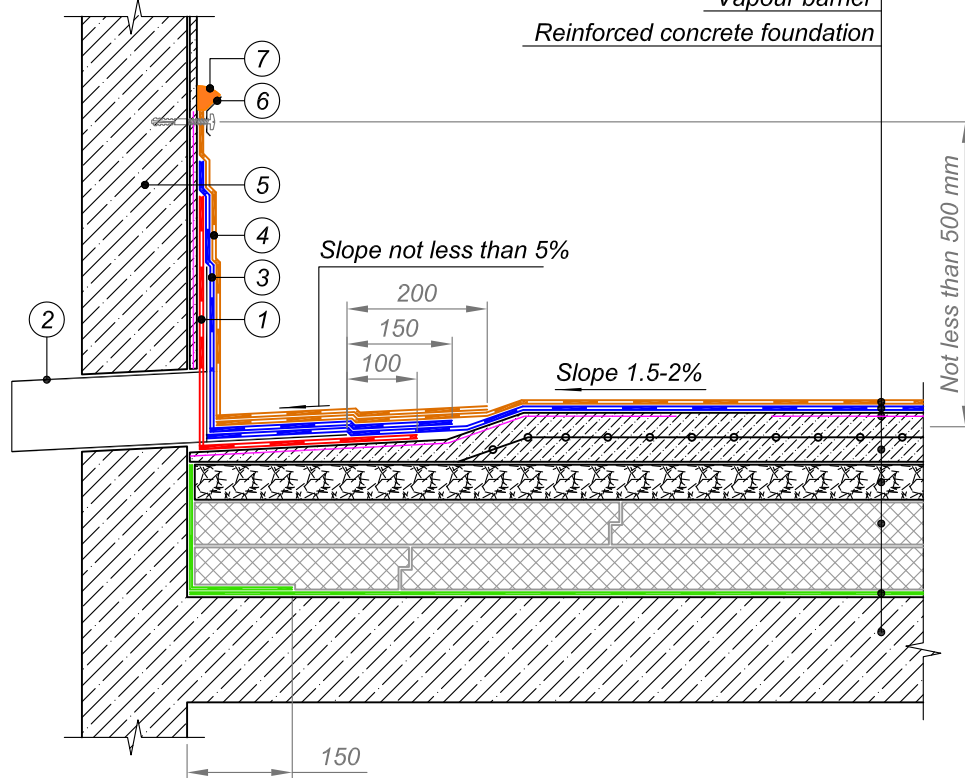

- Cap sheet torch-on bitumen membrane
- Underlay torch-on bitumen membrane
- Bitumen primer TECHNOMICOL No. 01
- Reinforced sand-cement screed
- Sloping of expanded clay gravel
- Extruded polystyrene
- TECHNONICOL CARBON PROF 300
- Vapour barrier
- Reinforced concrete foundation



- | | |
|--------------------------------------------------------------------------------------|---------------------------------------------------------------------------------------------|
| ① Strengthening layer - Underlay bitumen membrane | ⑤ Reinforced concrete wall plastered with cement-sand grout on metal grid fixed with screws |
| ② Funnel for parapet | ⑥ Edge strip to fastened by self-tapping screws at 200 mm intervals |
| ③ Bottom layer of system membrane on vertical surface - Underlay bitumen membrane | ⑦ Sealing mastic |
| ④ Top layer of waterproofing system on vertical surface - Cap sheet bitumen membrane | |

NOTES

1. Vapour barrier to be laid over the thermal insulation level.

				EXPOSED FLAT ROOF	DESIGN	APPROVED
				PARAPET OVERFLOW	SCALE	DATE
REV.	DATE	DESCRIPTION	CHECKED		DWG No.	REV.