

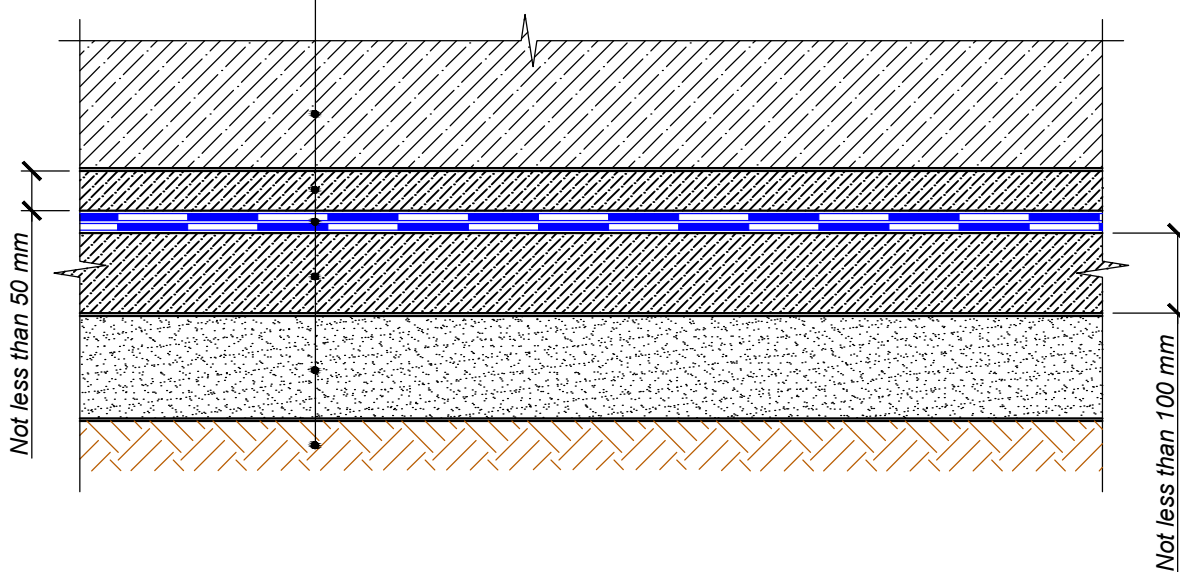

- Foundation slab
- Protective sand-cement screed
- Underlay waterproofing bitumen membrane - 2 layers*
- Concrete blinding
- Compacted leveling sand cushion
- Compacted soil foundation



**-first layer shall be laid freely and welded in overlaps, or built up on primer.*

				FOUNDATION WITH DRAINAGE	DESIGN	APPROVED
				STRUCTURE OF INSULATION SOLUTIONS. HORIZONTAL PART	SCALE	DATE
REV.	DATE	DESCRIPTION	CHECKED		DWG No.	REV.