

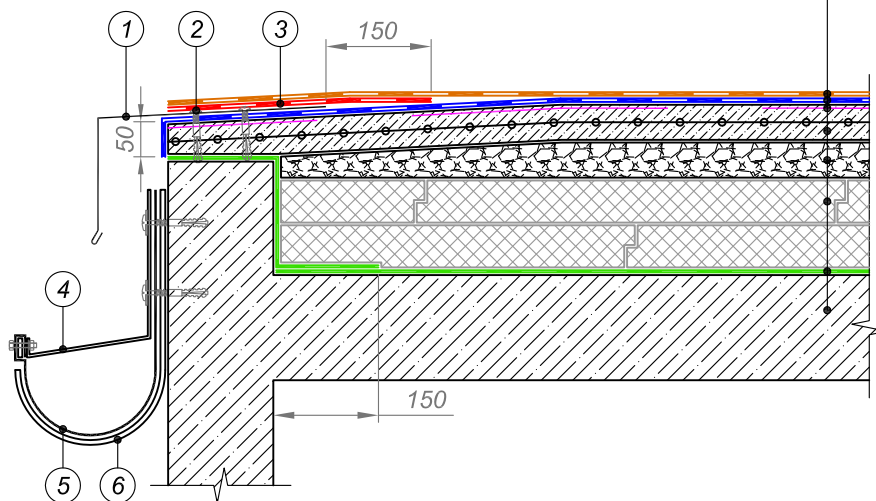

- Cap sheet torch-on bitumen membrane
- Underlay torch-on bitumen membrane
- Bitumen primer TECHNOMICOL No. 01
- Reinforced sand-cement screed
- Sloping of expanded clay gravel
- Extruded polystyrene
- TECHNONICOL CARBON PROF 300
- Vapour barrier
- Reinforced concrete foundation



Galvanized steel drip edge

Fastening elements 4, 5

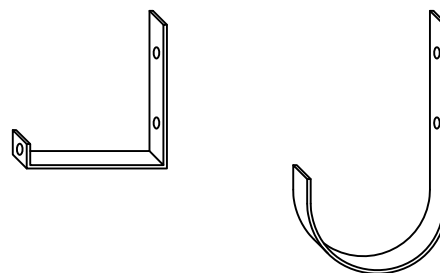
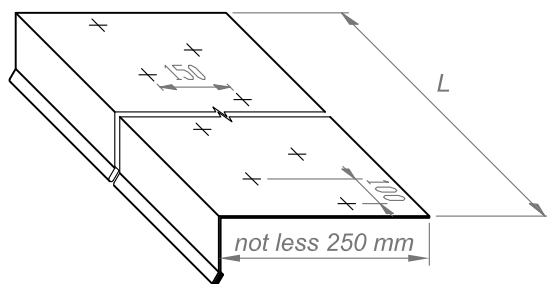

- ① Galvanized steel drip edge
(section length L not more than 4000 mm)
- ② Additional layer of underlay waterproofing bitumen membrane
- ③ Fastening by self-tapping screws at 100 mm intervals with staggered arrangement
- ④ Fastening elements to be arranged with intervals from 300 mm to 900 mm depending on the gutter design
- ⑤ Eaves gutter
- ⑥ Fastening elements to be arranged with intervals from 300 mm to 900 mm depending on the gutter design

				EXPOSED FLAT ROOF	DESIGN	APPROVED
				EXTERNAL CENTRALIZED DRAIN	SCALE	DATE
REV.	DATE	DESCRIPTION	CHECKED		DWG No.	REV.