

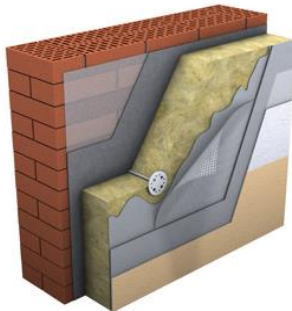

TECHNOFACADE COTTAGE

MW-EN 13162-T5- DS(70,-) DS(23,90)-CS(10)30-TR10-PL(5)250-WS-WL(P)-MU1 RtF:A1

TECHNOFACADE COTTAGE - nonflammable, water-repellent thermal and sound insulation stonewool slabs.



Application areas:

TECHNOFACADE COTTAGE slabs are designed to be used in ETICS facade systems.

Description of material:

Stonewool insulation boards. Provides an excellent combination of compressive and tensile strength as well as thermal, fire and acoustic performance. The product is moisture resistant due to a water repellent additive that provides additional protection during installation and long-term performance of insulation.

Storage:

The slabs must be stored in covered warehouses. Storage under an awning protecting the slabs from atmospheric precipitation is permitted. The slabs shall be stored into containers or stacked on the pallets or on the supports during whole period of storage. The height of the stack shall not exceed 3 meters.

Product technical data:

Essential characteristics	Performance	Harmonized technical specification
Declared thermal conductivity at 10 °C, W/m*K	0,036	EN 12667
Limit deviations Length, Width, mm	±2/±1,5 %	EN 822
Limit deviations of thickness, mm	T5	EN 823
Thickness, (with increments of 10 mm), mm	50-200	EN 823
Deviation from squareness, mm/m	< 5	EN 824
Deviation from flatness, mm	< 6	EN 825
Compressive stress at 10% deformation, kPa	CS(10)30	EN 826
Tensile strength perpendicular to faces, kPa	TR10	EN 1607
Point Load, N	PL(5)250	EN 12430
Dimensional stability, %: -at specified temperature -under specified temperature (23°C) and humidity conditions (90%R.H.)	DS(70,-) <1 DS(23,90) <1	EN 1640
Reaction to fire, euroclass	A1	EN 12086
Water Absorption during Short/ Longterm Immersion kg/m ²	WS <1 WL(P)<3	EN 1609 EN 12087
Dangerous Substances:	Does not include dangerous substances	