

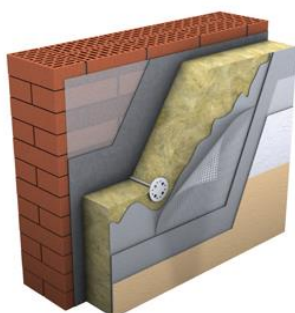

TECHNOFACADE COTTAGE

MW-EN 13162-T5- DS(70,-) DS(23,90)-CS(10)30-TR10-PL(5)150-WS-WL(P)-MU1 RtF:A1

TECHNOFACADE COTTAGE - nonflammable, water-repellent thermal and sound insulation slabs of mineral wool based on basalt rocks



Application areas:

TECHNOFACADE COTTAGE slabs are intended for use in civil and industrial construction as heat and sound insulation in systems for the external heating of walls with a protective decorative layer made of thin plaster coating. In the case when the height of the facade is not more than 10 m.

Description of material:

TECHNOFACADE COTTAGE - nonflammable, water-repellent thermal and sound insulation slabs of mineral wool based on basalt rocks.

Storage:

The slabs must be stored in covered warehouses. Storage under an awning protecting the slabs from atmospheric precipitation is permitted. The slabs shall be stored into containers or stacked on the pallets or on the supports during whole period of storage. The height of the stack shall not exceed 3 meters.

Product technical data:

Essential characteristics	Performance	Harmonized technical specification
Declared thermal conductivity at 10 °C, W/m*K	0,036	EN 12667
Limit deviations Length, Width, mm	±2/±1,5 %	EN 822
Limit deviations of thickness, mm	T5	EN 823
Thickness, (with increments of 10 mm), mm	50-200	EN 823
Deviation from squareness, mm/m	< 5	EN 824
Deviation from flatness, mm	< 6	EN 825
Compressive stress at 10% deformation, kPa	CS(10)30	EN 826
Tensile strength perpendicular to faces, kPa	TR10	EN 1607
Point Load, N	PL(5)150	EN 12430
Dimensional stability, %: -at specified temperature -under specified temperature (23°C) and humidity conditions (90%R.H.)	DS(70,-) <1 DS(23,90) <1	EN 1640
Reaction to fire, euroclass	A1	EN 12086
Water Absorption during Short/ Longterm Immersion kg/m2	WS <1 WL(P)<3	EN 1609 EN 12087
Dangerous Substances:	Does not include dangerous substances	