

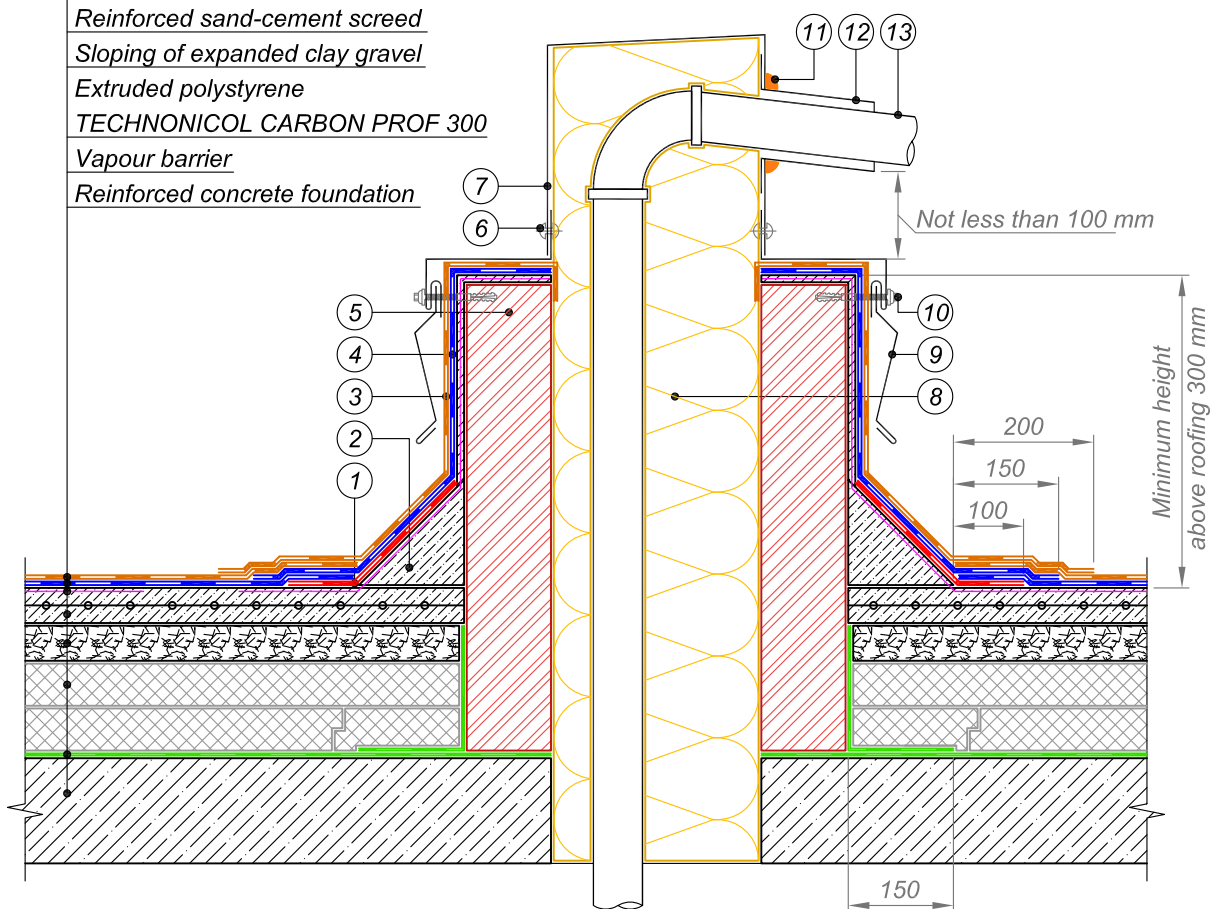

Cap sheet torch-on bitumen membrane
 Underlay torch-on bitumen membrane
 Bitumen primer TECHNICAL No. 01
 Reinforced sand-cement screed
 Sloping of expanded clay gravel
 Extruded polystyrene
 TECHNICAL CARBON PROF 300
 Vapour barrier
 Reinforced concrete foundation



- | | |
|---|---|
| <p>① Additional layer of waterproofing membrane - Underlay bitumen membrane</p> <p>② Transitional upstand of lightweight concrete</p> <p>③ Top layer of waterproofing system at junction - Cap sheet bitumen membrane</p> <p>④ Bottom layer of waterproofing system at junction - Underlay bitumen membrane</p> <p>⑤ Brickwork plastered with cement-sand grout</p> | <p>⑥ Fasten with combined rivets</p> <p>⑦ Metal cover</p> <p>⑧ Fill with stone wool thermal insulation</p> <p>⑨ Removable metal flashing</p> <p>⑩ Fasten by roofing self-tapping screws with EPDM gasket at intervals not more than 450 mm</p> <p>⑪ Sealant *</p> <p>⑫ Металлический или резиновый хомут</p> <p>⑬ Tip chute</p> |
|---|---|

NOTES

* Polyurethane sealant to be applied at temperatures up to 80°C.

At high temperatures use specialized high-temperature sealants.

EXPOSED FLAT ROOF				DESIGN	APPROVED
JUNCTION TO HOT PIPES BUNDLE. VARIANT 2				SCALE	DATE
				DWG No.	REV.
REV.	DATE	DESCRIPTION	CHECKED		