

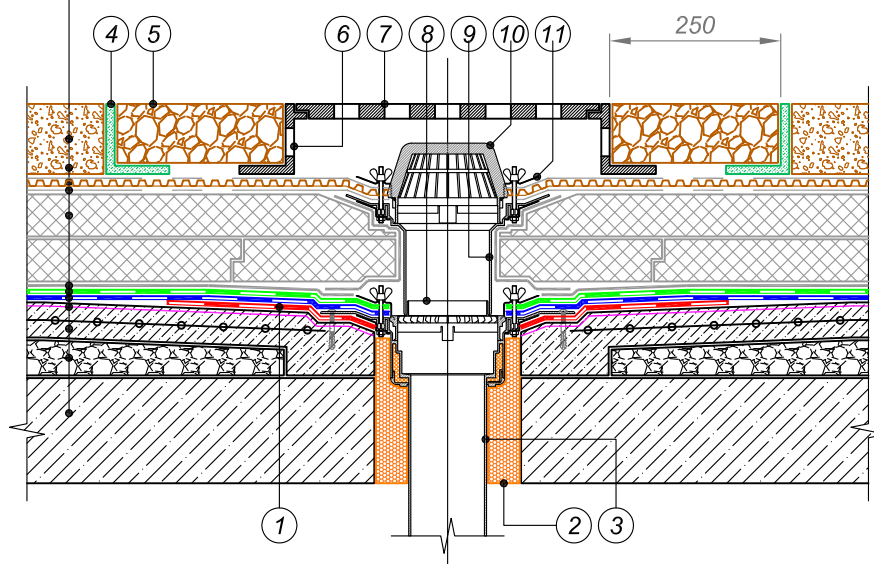

Plant substrate with green planting  
Drainage membrane with geotextile  
Heat-treated needle-punched geotextile 150 g/sq.m  
Extruded polystyrene  
TECHNICOL CARBON PROF 300  
Heat-treated needle-punched geotextile 300 g/sq.m  
Anti-root waterproofing bitumen membrane  
Underlay waterproofing bitumen membrane  
Bitumen primer  
TECHNICOL No. 01  
Reinforced sand-cement screed  
Sloping of expanded clay gravel  
Reinforced concrete foundation



- |   |                             |
|---|-----------------------------|
| ① Additional layer of waterproofing membrane -<br>Underlay waterproofing bitumen membrane | ①⑦ Drainage nozzle          |
| ② Sealing foam  | ①⑧ Drainage grating         |
| ③ Rainwater funnel  | ①⑨ Drainage ring            |
| ④ L-shaped plastic element  | ①⑩ Funnel extension element |
| ⑤ Washed gravel of big fraction   | ①⑪ Gutter leaf debris trap  |
|   | ①⑫ Compression flange       |

**NOTES**

\* To provide for increase in slope to the funnel up to 5% within radius of not less than 500 mm around it. It is recommended to provide for the funnel deepening by 20-30 mm relative to the roof level.

				GREEN ROOF	DESIGN	APPROVED
				RAINWATER FUNNEL	SCALE	DATE
REV.	DATE	DESCRIPTION	CHECKED		DWG No.	REV.