

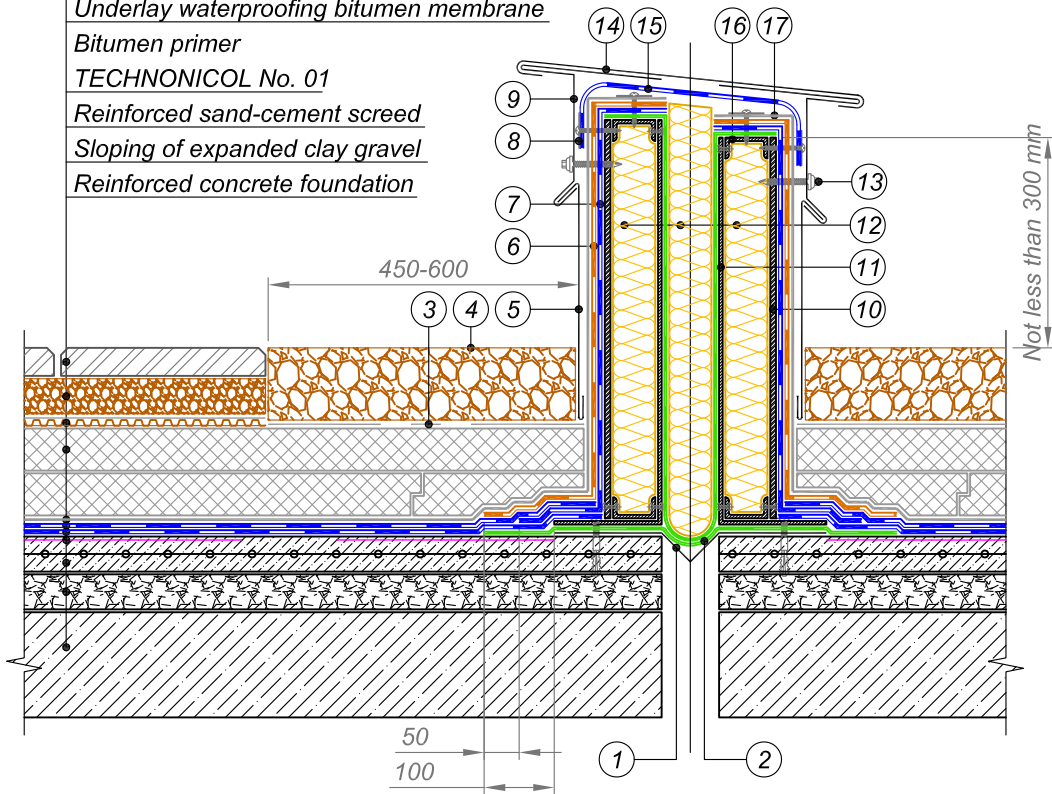

Protective-decorative coating
Washed gravel, fraction 2-5 mm
Drainage membrane with geotextile
Extruded polystyrene
TECHNICOL CARBON PROF 300
Heat-treated needle-punched
geotextile 300 g/sq.m
Underlay waterproofing bitumen membrane
Underlay waterproofing bitumen membrane
Bitumen primer
TECHNICOL No. 01
Reinforced sand-cement screed
Sloping of expanded clay gravel
Reinforced concrete foundation



- | | |
|---|---|
| <ul style="list-style-type: none"> ① Galvanized steel compensator to be fastened from one side at 600 mm intervals ② Vapour barrier ③ Heat-treated needle-punched geotextile 150 g/sq.m ④ Washed gravel ⑤ Removable metal flashing ⑥ Cap sheet bitumen membrane ⑦ Underlay bitumen membrane ⑧ Fasten by self-tapping screws with washer \varnothing 50 mm at 250 mm intervals ⑨ Fastening element | <ul style="list-style-type: none"> ⑩ CBPB or ACB ⑪ Galvanized steel profile not less than 3 mm in thickness ⑫ Stone wool thermal insulation ⑬ Fasten by roofing self-tapping screws with EPDM gasket ⑭ Coating of galvanized sheet ⑮ Roofing material flashing ⑯ Galvanized steel profile to be fastened by rivets ⑰ Vapour barrier material for fixation of insulation |
|---|---|

				TERRACE WITH DRAINAGE	DESIGN	APPROVED
					SCALE	DATE
REV.	DATE	DESCRIPTION	CHECKED	DEFORMATION SEPARATOR	DWG No.	REV.